



奥凯沃硬质合金工具有限公司
AoKai Wo Carbide Tool Co.Ltd

铲雪机硬质合金刀片
SNOW PLOW carbide insert



硬质合金插入犁刀片

Tungsten Carbide Inserted Plow Blades

奥凯沃硬质合金插入犁刀片使用最好的质量烧结原始碳化钨刀片可用。硬质合金刀片钎焊到刀片磨损边缘的铣削槽中，以延长刀片寿命

AoKai Wo Cemented carbide insert plow blades are available using the best quality sintered raw tungsten carbide blades. The cemented carbide insert is brazed to the milling groove on the worn edge of the blade to extend the blade life
这些硬质合金刀片是一种极其坚硬的材料，其耐磨性约为钢刀片的20倍。钢刀片主要是硬质合金刀片的“固定器”。

These carbide inserts are an extremely hard material that will resist wear by an estimated 20 times over steel blades. The steel blade is primarily the “holder” for the carbide inserts which alone are too fragile to be used for plowing roadways.

插入刀片的不同尺寸和形状旨在以不同的配置安装在使用中的许多不同的雪犁上碳化钨保护选项
The different sizes and shapes of the inserted blade are designed to allow mounting in different configurations on the many different snow plows in use around the world.

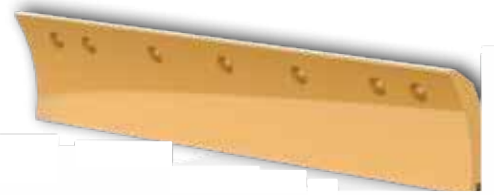

Carbide Protection Options



防护屏
Shield



硬质合金板覆盖
carbide overlay plate covering

碳化钨是一种非常坚硬的耐磨材料，磨损非常好。由于硬度高，刀片在某些应用中会发生压裂。有几个选项可用于保护硬质合金刀片，以延长刀片的使用寿命。BCB护罩用于吸收冲击和冲击，有助于消除碳化物断裂。硬质合金覆盖层应用于钢支架刀片的表面，以硬化表面并保持在研磨应用中，避免面部磨损过快。一种耐冲击级硬质合金是终极接触地面工作。

Tungsten Carbide is an extremely hard wear material that will resist abrasion very well. Because of this high hardness, the inserts are subject to fracturing in some applications. Several options are available to protect the carbide insert to prolong the life of the blade. The BCB Shield is applied to absorb shock and impact to help eliminate carbide fracturing. Carbide Overlay is applied to the face of the steel holder blade to harden the surface and keep the face from wearing too quickly in abrasive applications. Carbide Over Carbide is the ultimate in protection, an impact grade carbide tile is brazed in place over the high wear grade carbide insert to absorb shock and eliminate face wear.

碳化钨刀片

Tungsten Carbide Inserts

各种硬质合金刀片可供选择，以适应多种不同的应用和要求。刀片是25度梯形。一些机构指定更大的插入物，如40度陷阱插入件的尺寸和形状通常由请求机构指定。

Several carbide insert options are available to suit the many different applications and requirements. The most popular insert in North America is the 25 degree trapezoid shape. Some agencies specify larger inserts like the 40 degree trap. The size and shape of the insert is often specified by the requesting agency.

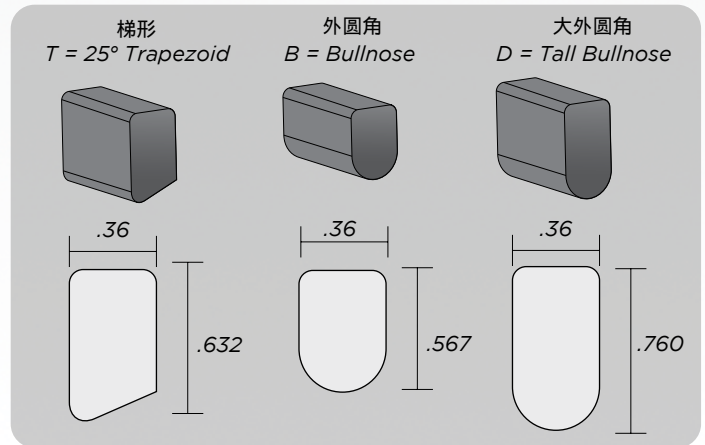

硬质合金雪犁片耐高磨损 High wear resistance of carbide snow plow blade

规格 Specifications	每件重量 Weight per
1/2" x 6"	10.20 lbs
5/8" x 6"	12.72 lbs
3/4" x 6"	15.36 lbs
1" x 6"	20.38 lbs
5/8" x 8"	17.04 lbs
3/4" x 8"	20.40 lbs
1" x 8"	27.24 lbs

硬质合金ak12，以提高耐磨性和冲击力量犁刀片非常坚固，保证不会损坏在其使用寿命期间！如果这些刀片在磨损之前断裂。

Hard alloy ak12, to improve wear resistance and impact strength, the plough blade is very solid, ensuring no damage

前沿边缘硬质合金雪犁刀套件 Front edge carbide snow plow knife kit



加厚型硬质合金圆角路缘板块
Thickened cemented carbide fillet curb plate

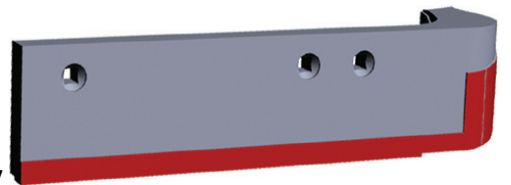

规格：

加厚型硬质合金路缘板圆角与道路的接触耐冲击,加固底部耐磨板,长度23.5",使用寿命更长1.0英寸厚,以尽量减少雪雾和石块碎片进入车道

L/路缘铠装1x6x21左侧-硬质合金路缘护板

R/路缘装甲1x6x21右侧硬质合金板路缘防护

S/路缘铠装1x6x22直型条硬质合金板

The contact between the thickened cemented carbide curb fillet and the road is impact resistant, and the bottom wear-resistant plate is reinforced. The length is 23.5 ", and the service life is longer. The thickness is 1.0 inch, so as to minimize the snow fog and stone fragments entering the driveway

L/curb armouring 1x6x21 left side - carbide curb guard

R/curb armor 1x6x21 right hard alloy plate curb protection

S/kerb armour 1x6x22 straight strip hard alloy plate

组装靠背钢板套件

Assembling backrest steel plate kit

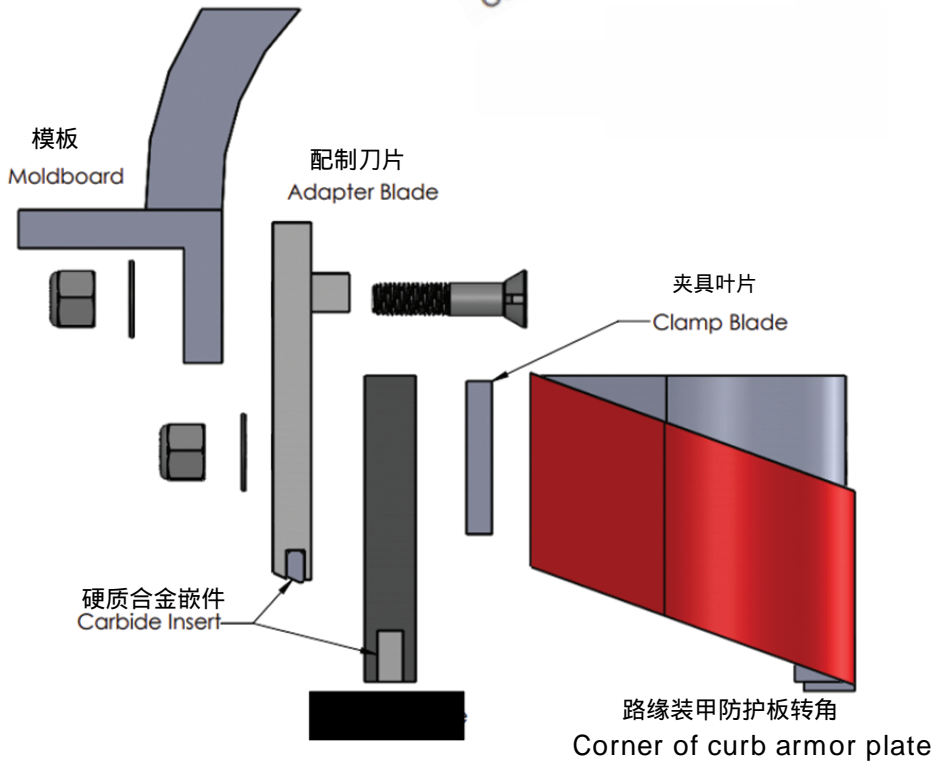
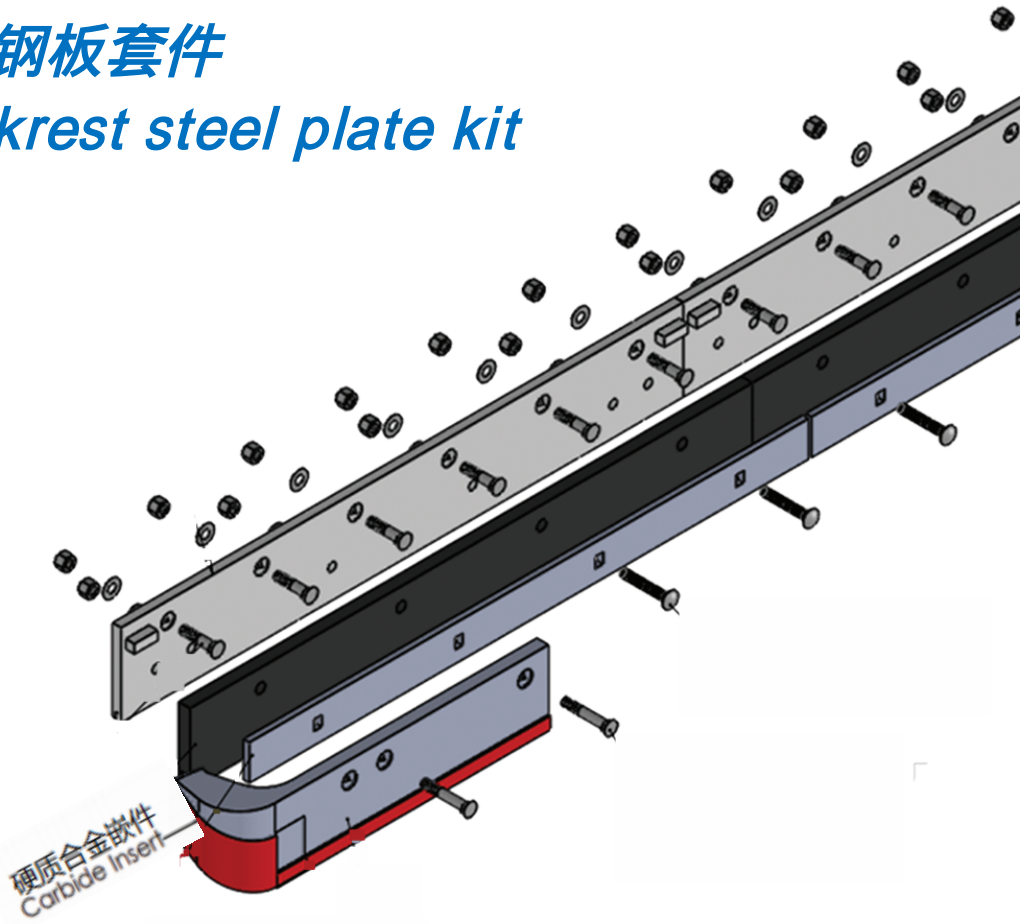

耐磨路缘护板

Wear resistant curb guard

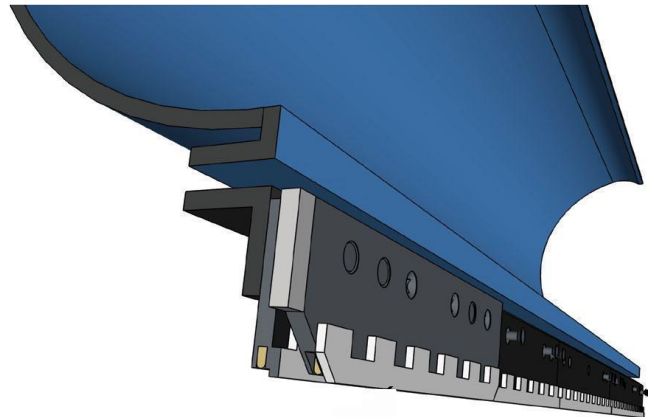
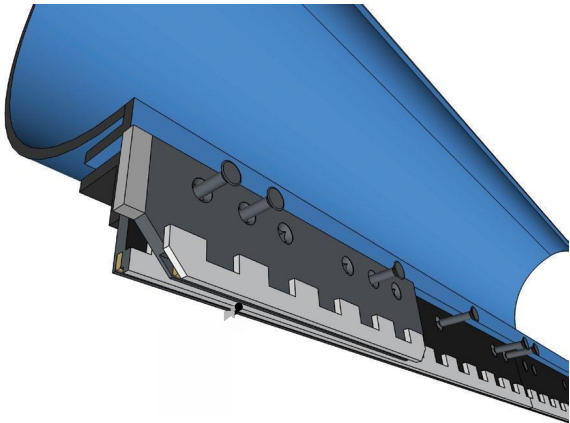
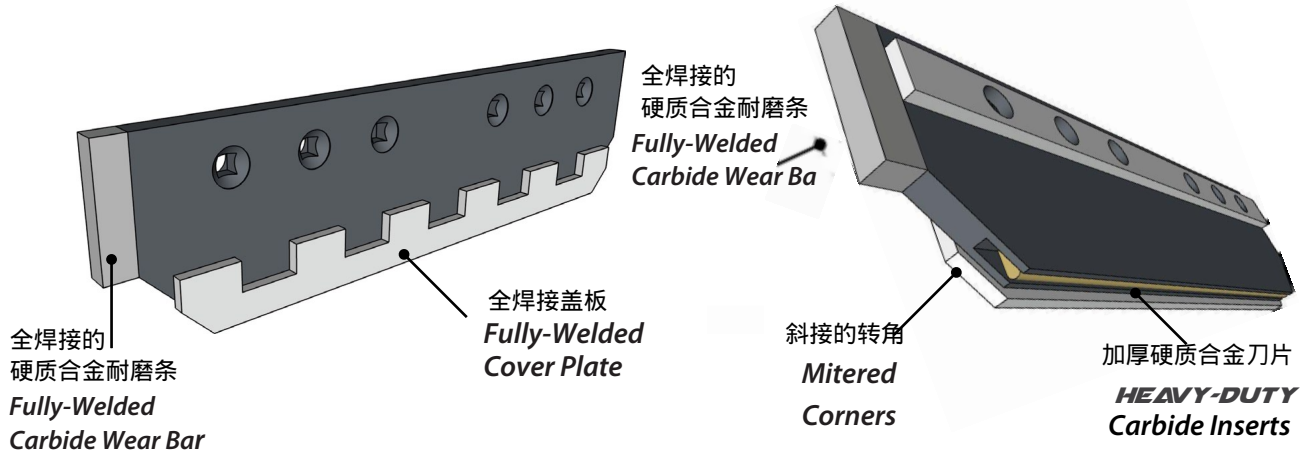

硬质合金铲雪犁片 CARBIDE SNOW PLOW BLADE

硬质合金模板 CARBIDE MOLDBOARD SHOES

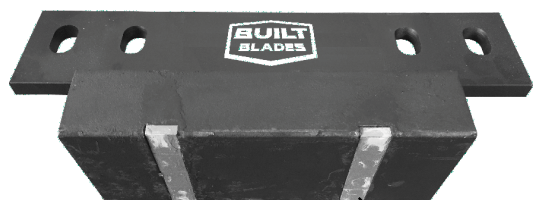

超宽硬质合金刀片
Extra-Wide Carbide Inserts

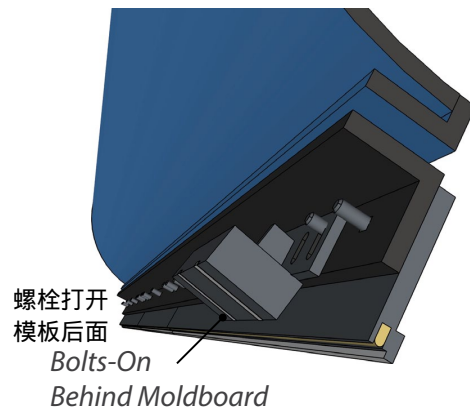
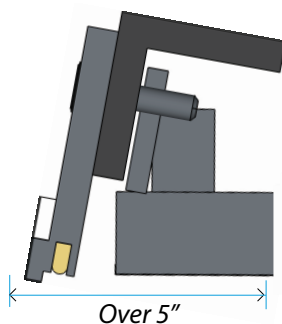

在中可用
多个角度
Available in
Multiple Angles

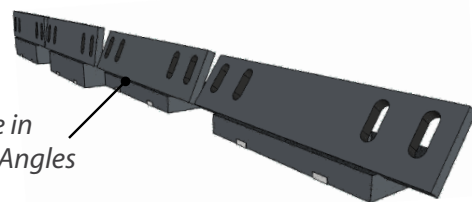

硬质合金框架 CARBIDE FRAME SHOES

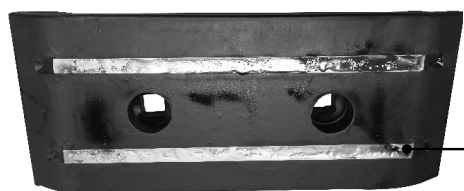

硬质合金刀片
与对齐行驶方向
Carbide Inserts
Aligned with
Travel Direction

附加到犁架
Attaches to
Plow Frame

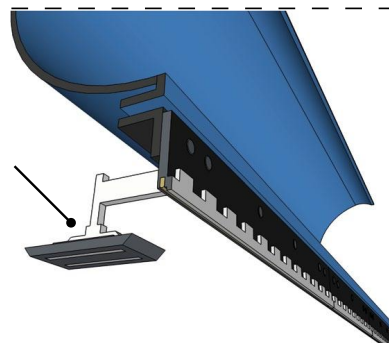

- EBT-CWS-55/55°硬质合金耐磨件
- EBT-CWS-65/65°硬质合金耐磨件
- EBT-CWS-80/80°硬质合金耐磨件
- EBT-CWS-85/85°硬质合金耐磨件
- EBT-CFS-UNI/ 通用硬质合金件
- EBT-CFS-BOAT/ “船”式硬质合金件

说明: Description

- EBT-CWS-55 / 55° Carbide Wear Shoe
- EBT-CWS-65 / 65° Carbide Wear Shoe
- EBT-CWS-80 / 80° Carbide Wear Shoe
- EBT-CWS-85 / 85° Carbide Wear Shoe

硬质合金雪犁片

Hard alloy snow plow blade

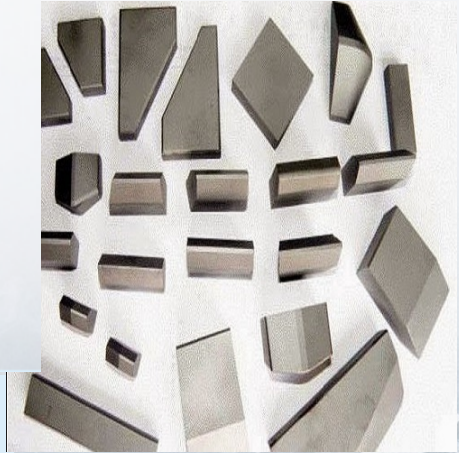
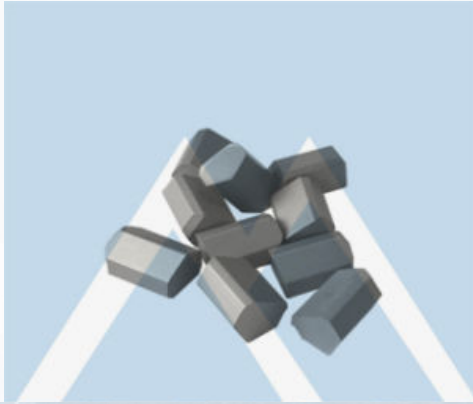

奥凯沃硬质合金工具有限公司

AoKai Wo Carbide Tool Co.Ltd

地址：湖南省株洲市荷塘区嘉德工业园

A5-2Add: A5-2 , Jiade Industrial Park,Hetang District

ZhuzhouCity,Hunan Province, China

电话 Tel: 0086-731-28835805

传真 Fax: 0086-731-22795610

邮箱Email:grand@akotool.com

网址 Website :www.carbideakotool.com